

# SINGLE BEND ELECTRODES



NSRW Co., Inc. (800) 933-6779, FAX: (205) 663-3221 Authorized Distributor CMW Inc.

CMW® 3 single bend electrodes are cold formed from full hard straight electrodes, and have properties superior to those obtained by casting or hot forging methods. Cooling tubes are bent in place, if requested, to provide water flow as near to the welding face as in the case of straight electrodes. These extra values assure you a more efficient, less costly electrode for gun welders and special offset welding applications.

Furnished with water tubes as specials to your order. Other nose types available to order. For dimensions not shown here see straight electrode (round water hole) measurements on page 12, 13 and 14. CMW® 28 material available on special order.

## SINGLE BEND

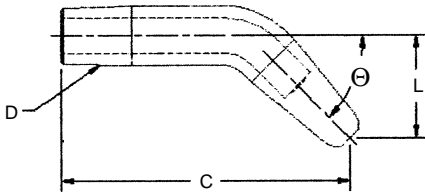

Part No.	Reference Length to $\odot$ of Face "C"	Taper "D"	Offset $\odot$ of Taper to $\odot$ of Face "L"	Bent Angle " $\Theta$ "
3214-04-15	1 11/16		1/4	15°
3219-04-15	2 15/16	4RW	1/4	
32118-13-15	3 7/8	1MT	13/16	
3225-04-15	1 7/8		1/4	
3229-04-15	2 7/8	5RW	1/4	
32218-10-15	3 13/16	2MT	5/8	
3215-07-30	1 7/8		7/16	30°
3219-07-30	2 7/8	4RW	7/16	
32118-23-30	3 5/8	1MT	1 7/16	
3226-09-30	2 1/16		9/16	45°
32212-09-30	3 1/16	5RW	9/16	
32220-24-30	3 13/16	2MT	1 1/2	
3215-10-45	1 11/16		5/8	60°
32112-12-45	2 7/8	4RW	3/4	
32118-33-45	3 1/8	1MT	2 1/16	
3228-17-45	2 1/4		1 1/16	75°
32214-17-45	3	5RW	1 1/16	
32220-33-45	3 3/8	2MT	2 1/16	
3218-23-60	2		1 7/16	60°
32116-23-60	3	4RW	1 7/16	
32118-40-60	2 5/8	1MT	2 1/2	
32212-25-60	2 3/8		1 9/16	75°
32218-25-60	3 1/8	5RW	1 9/16	
32220-38-60	3	2MT	2 3/8	
32216-35-75	2 5/16		2 3/16	75°
32220-37-75	2 11/16	5RW	2 5/16	
32220-43-75	2 3/8	2MT	2 11/16	

## RADIUS BEND

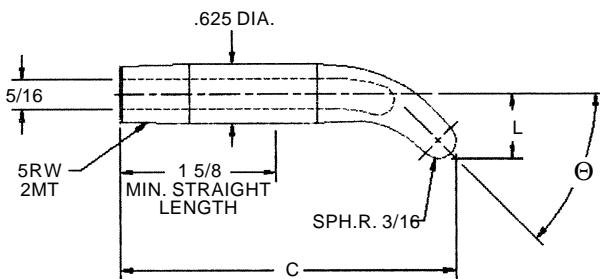

Part No.	O.A.L. "C"	Offset $\odot$ of Taper to Top of Radius "L"	Bent Angle " $\Theta$ "
16-26015	3 11/16	3/8	15°
16-26030	3 5/8	33/64	30°
16-26045	3 1/2	43/64	45°
16-26060	3 3/8	27/32	60°
16-26075	3 5/32	1 1/32	75°
16-26090	2 13/16	1 1/4	90°

Radius bend electrodes are designed for use with 18-768 & 18-784 straight universal adapters shown on page #35.

See Page 6 for Metric Conversion  
See Page 7 for Taper Dimensions